

## Mortar Probe V0011

Mortar probe made of hardened stainless steel. This is used for mortar with a maximum particle size of 2 mm . Using of a scraper is recommended for this probe.  
Weight 41g



## Cement Paste Probe V0013

Cement paste probe made of stainless steel. This probe is used for cement paste and mortar with a maximum particle size of 0.5 mm.



## Modified Cement Paste Probe V0003

formed like the standard cement-paste-probe, but for suspension up to 2 mm of max. grain diameter. Built in temperature sensor RTD PT100 1/3 DIN B



## Scraper V0021

Scraper made of hardened stainless steel. Strongly recommended for mortar.



## Cylinder Probe V0070

Cylindrical formed test probe for the Viskomat NT. Including beaker, and probe. Couette system according to DIN 53019. diameter 50mm, bottom cone formed,  $\Delta = R_{outer}/R_{inner} = 1.0847$ , gap size 2.12 mm, specimen volume 127.7 ml. Beaker height 150mm, At 100 rpm and 200 Nmm: shear rate 129.08



1/s, shear stress 570.4 Pa, viscosity 4.42 Pa\*s. Including RTD for temperature measurement.

Net weight 2.3 kg

## Cone Plate Probe V0002

specially developed for glue like specimen. Fits best for speeds between 0 and 0.5 rpm. Diameter of the cone: 100 mm



## Basket Probe V0014

invented by Prof. R. Vogel, Weimar. Double gap system with a net formed surface. Specially

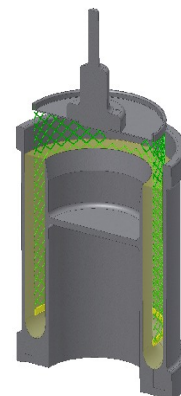

developed for self compacting mortars. Including special vessel and calibration certifi-caten

## Ball-Probe-System V0007

With three spheres 10mm, 20mm und 30mm diameter. Special vessel 140mm diameter, inner height 80mm.

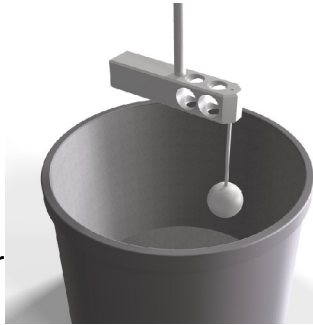

Probe and vessel made of stainless steel.

## Vane-Probe V0004 with Special Vessel V0005

Probe with 6 wings, diameter 40mm, height 60 mm. Vessel with inner diameter of 100mm, inner height 110 mm. Incl. Temperature sensor.



## Beaker for Temperature Control V0009

A double wall beaker, so that the measurement beaker is running in a water bath, which was circulated by an



external cooling/heating unit for example unit V0019, net weight 2.2 kg

## Circulating Cooling and Heating Unit V0019

Unit for cooling and heating water incl. a circulating pump. Temperature range 0..65 °C, Deviation better then 0.2 K, digital temperature control unit with digital LED display, air cooling, cooling power 300W at 20°C, heating power 1.0 kW, circulation pump rate max. 18 l/min, max. pumping height 3mWS, RS232 interface, touch-screen, main power 1.2 kW, wxdxh 35x44x53 cm, net weight 25,3 kg



## Shear Stress Controlled Drive V0006

Shearstress controlled measurement. You can run torque ramps ore torque-steps, angel-ramps or angel-steps. The torque is measured with a resolution of 0.1 Nmm. The angel is measured with an resolution of 0.01°. Internal resolution 0.001°

## Oscillation-Mode for the Viskomat NT V0030

Oscillation mode: max. amplitude 3.6°, max. frequency 5 Hz. Hint: the standard probes are not symmetric